

# The Bag Organizer

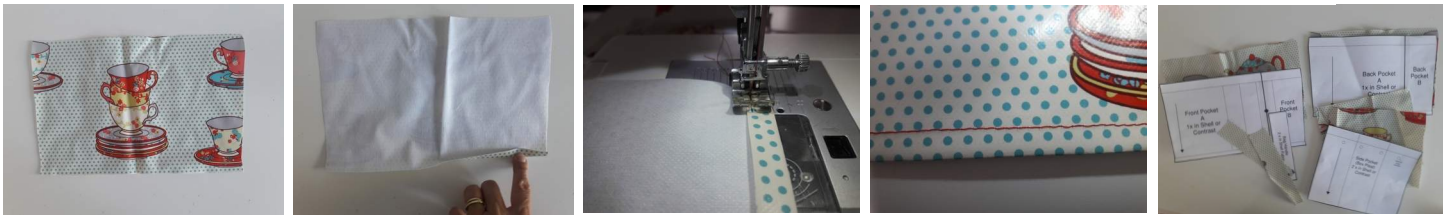

Assemble the pattern and cut out pockets and main bag body. In the example I used a different fabric for the pockets. It had a tea cup theme so I had to make sure the cups were positioned well when I was cutting out. Construct the handles. Turn in from both sides and then towards the center. Topstitch from either side.



Turn the lower end of the pocket up 1 cm and top stitch. Aline the presser foot with the edge of the fabric. Repeat for all 4 pockets.



Turn in the top edge 2 cm and topstitch 1.5 cm from the edge. Do this on all pockets.



Turn in the edges of the main bag body by 1 cm. To create the pocket with the box pleat, place the pocket on top of the pattern piece. Fold over one side as indicated on the pattern and topstitch close to the edge. Repeat on the other side. Sew each side of the pocket to the side of the bag body. The pocket should end 1 cm below the end of the side. Close the lower edge of the pocket. Start 1 cm into the pocket and end 1 cm before the end of the pocket.



Now we are sewing the plain pocket on. Place the pocket on the bag body, so the sides are on top of each other and the lower edge also sits 1 cm lower. The pockets will start overlapping. You can topstitch down the center of the bag to create two separate pockets. Close the lower edge of the pocket. Start 1 cm into the pocket and end 1 cm before the end of the pocket.





You can topstitch down the center of the bag to create two separate pockets. Close the lower edge of the pocket. Start 1 cm into the pocket and end 1 cm before the end of the pocket.

Now we can attach the pocket which will hold the pens etc. Mark the lines as shown on the pattern piece. I used ball pen as this line will not be seen.



Begin by topstitching the outer lines first. I placed my textile marker into the right side to identify where my next stitching line was to go, as I found it difficult to see my markings. This will be easier if the fabric isn't laminated which you can readily pin and mark with a textile marker. In that case I would mark both the pocket and the bag body and then align the markings. Finally topstitch the lower edge placing a small pleat into end to get rid of the excess.



Trim the pockets diagonally. This will reduce the excess fabric and ensure a flat seam. Close the sides of the bag with 1 cm seam allowance.



Attach the handles to the wrong side of the bag, as indicated on the pattern.

Voila..... Your bag is done. Place it inside of your 'Out & About' bag and marvel at your work!

